

Codice - Code:

L00689
TETIS columnns

Descrizione - Description:

Colonna doccia TETIS in acciaio inox AISI 316 - Kit di fissaggio a pavimento per collegamento idraulico (acqua fredda) - rubinetto a tempo - Soffione TETIS Ø300 mm
TETIS Stainless steel inox AISI 316 shower column - Floor fixing installation kit for water pipe connections (cold water) - self-closing valve - Showerhead TETIS Ø300 mm
TETIS Duschsäule aus Edelstahl AISI 316 - Set für Boden Befestigung der Wasseranschlüsse (kaltwasser) - Selbstschluss - TETIS Kopfbrause Ø300 mm

Tecnologia - Technology:



Colonne douche TETIS en acier inox AISI 316 - Kit de fixation au sol pour la connexion de l'eau (froide) - robinet temporisé - Pomme douche TETIS Ø300 mm

Columna ducha TETIS de acero inoxidable inox AISI 316 - Kit de fijación a pavimento para la conexión del agua (fría) - grifo temporizado - Rociador TETIS Ø300 mm

Душевая колонна TETIS, из стали INOX AISI 316, с подключением к водоснабжению встроенному в пол. Комплект душевой колонны состоит из: Комплект для крепления к полу и подключению к водоснабжению (холодному) - Вентиль подачи на время - Душ TETIS диам. Ø300 мм

Immagine Prodotto - Product Image



KIT FISSAGGIO A PAVIMENTO
FLOOR FIXING INSTALLATION KIT

Disegni - Drawings



Grafico di portata - Flow rate diagram

	rain
0	0,0
0,5	7,2
1	11,4
1,5	13,4
2	14,5
2,5	14,5
3	14,5
3,5	14,7
4	15,0
4,5	15,3
5	15,4
pressione bar	portata L/min

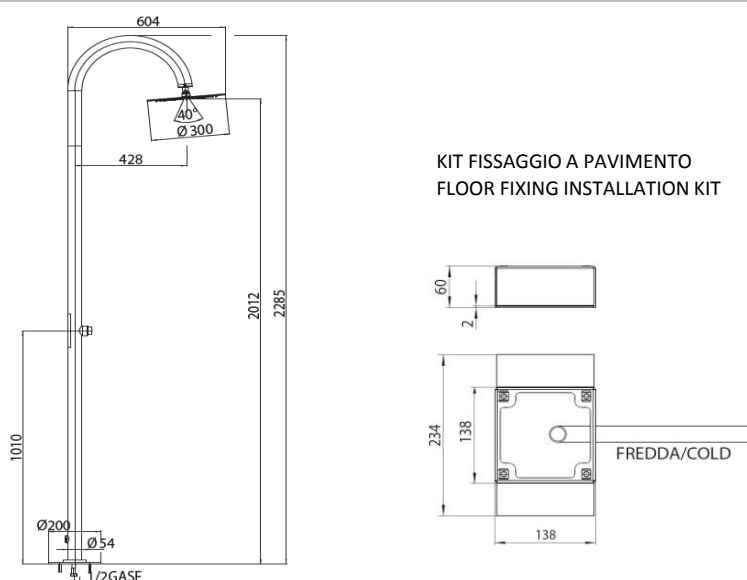
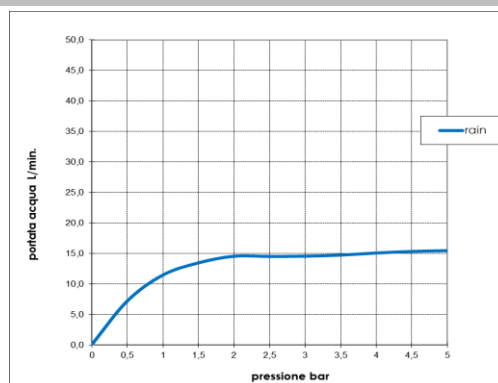

Caratteristiche idrauliche - Hydraulic features

	Pressione Pressure	Portata Flow rate
min	1 bar	11,4 L/min
max	5 bar	15,4 L/min
Portata minima consigliata per buon funzionamento <i>Recommended minimum flow-rate for optimal performance</i>		10 L/min

Solo per miscelatori termostatici Only for thermostatic mixers	
Blocco di sicurezza Safety lock	--
Temperatura acqua fredda Cold water temperature	--
Temperatura acqua calda Hot water temperature	--

Materiali - Materials

Colonna doccia: Acciaio inox AISI 316

Soffione TETIS 100872: Corpo in acciaio inox AISI 304 e ugelli in silicone, connessione in ottone

Shower column : *Stainless steel AISI 316*

Showerhead TETIS 100872 : *Stainless steel AISI 304 body and silicone nozzles, brass connection*

Certificazioni - Certifications

Conformità' - Conformity

Chrome plating (brass) - EN248